

MODEL 5600SE

Downflow Brining

Service Manual



MODEL 5600SE Downflow

Job Specification Sheet

Job Number _____

Model Number _____

Water Test _____

Capacity Of Unit _____ Max. _____ Per Regeneration

Mineral Tank Size: Diameter _____ Height _____

Under Bedding _____ Amount _____

Type Of Media _____ Cubic Feet _____

Brine Tank Size _____

Salt Setting Per Regeneration _____

Valve Programming

Treated Water Capacity _____ (Gallons / Liters)

Regeneration Day Override _____ (Max. Days Between Regen.)

Regeneration Time _____ (A.M.) (P.M.)

Notes:

MODEL 5600SE Downflow

General Residential Installation Check List

WATER PRESSURE: A minimum of 25 pounds of water pressure is required for regeneration valve to operate effectively.

ELECTRICAL FACILITIES: An uninterrupted alternating current (A/C) supply is required. Please make sure your voltage supply is compatible with your unit before installation.

EXISTING PLUMBING: Condition of existing plumbing should be free from lime and iron buildup. Piping that is built up heavily with lime and/or iron should be replaced. If piping is clogged with iron, a separate iron filter unit should be installed ahead of the water softener.

LOCATION OF SOFTENER AND-DRAIN: The softener should be located close to a clean working drain and connected according to local plumbing codes.

BY-PASS VALVES: Always provide for the installation of a by-pass valve if unit is not equipped with one.

CAUTION: Water pressure is not to exceed 120 p.s.i., water temperature is not to exceed 110°F, and the unit cannot be subjected to freezing conditions.

Valve Installation And Start-Up Procedures

1. Place the softener tank where you want to install the unit, making sure the tank is level and on a firm base.
2. During cold weather it is recommended that the installer warm the valve up to room temperature before operating.
3. All plumbing should be done in accordance with local plumbing codes. The pipe size for the drain should be a minimum of 1/2". Backwash flow rates in excess of 7 gpm or length in excess of 20' require 3/4" drain line.
4. The 1" distributor tube (1.050 O.D.) should be cut flush with top of each tank. Note:-Only use silicone lubricant.
5. Lubricate the distributor o-ring seal and tank "o" ring seal. Place the main control valve on tank.
6. Solder joints near the drain must be done prior to connecting the Drain Line Flow Control fitting (DLFC). Leave at least 6" between the DLFC and solder joints when soldering pipes that are connected on the DLFC. Failure to do this could cause interior damage to DLFC.
7. Teflon tape is the only sealant to be used on the drain fitting.
8. Make sure that the floor is clean beneath the salt storage tank and that it is level.
9. Place approximately 1" of water above the grid plate. If a grid is not utilized, fill to the top of the air check in the salt tank. Do not add salt to the brine tank at this time.
10. On units with a by-pass, place in by-pass position. Turn on the main water supply. Open a cold soft water tap nearby and let run a few minutes or until the system is free from foreign material (usually solder) that may have resulted from the installation. Once clean, close the water tap.
11. Place the by-pass in service position and let water flow into the mineral tank. When water flow stops, slowly open a cold water tap nearby and let run until the air is purged from the unit. Then close tap.
12. Plug the valve into an approved power source. Once the valve is powered it will drive to the Service Position.

MODEL 5600SE Downflow

Control Start-Up Procedures

1

Set Time Of Day

Service Indicator:

Valve In Service - Dot On
Extra Cycle Tonight - Flashing Dot

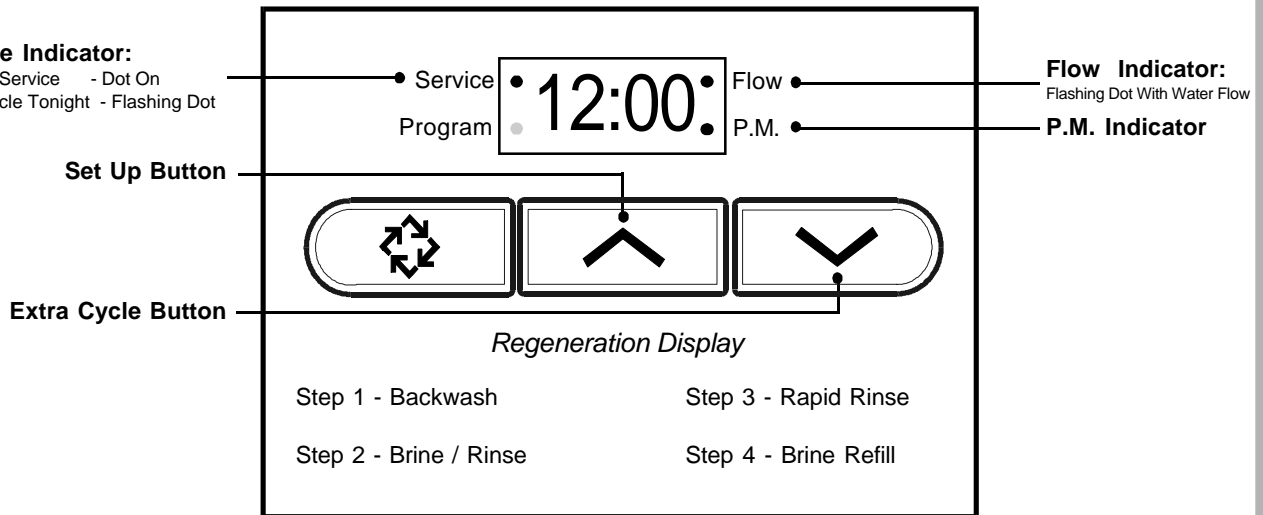

Push either the Up or Down Set Button once to adjust Time Of Day Display by one digit.
Push and hold either Up or Down Set Button to adjust Time Of Day Display by several digits.

2

Enter Control Programming Mode

Program Mode Indicator:

Program Mode Entered - Dot On

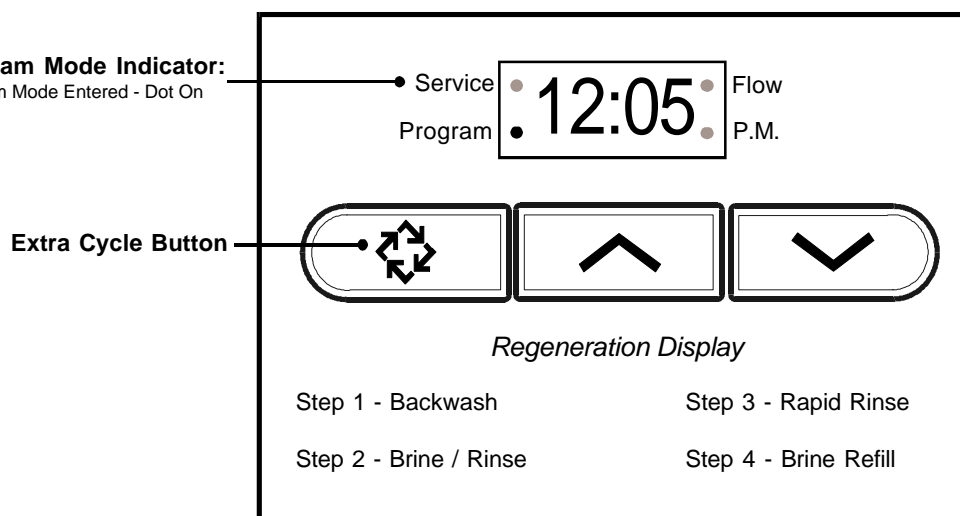

1. Push and hold for 5 seconds *both* the Up and Down Set Buttons to enter Programming Mode.
2. Push the *Extra Cycle Button* once per display until all have been viewed and this mode is exited and normal operation is resumed.

MODEL 5600SE Downflow

Control Start-Up Procedures, Continued

Depending on current control programming, option setting displays that are not required to be set will not be viewed.

3 Set Control Programming

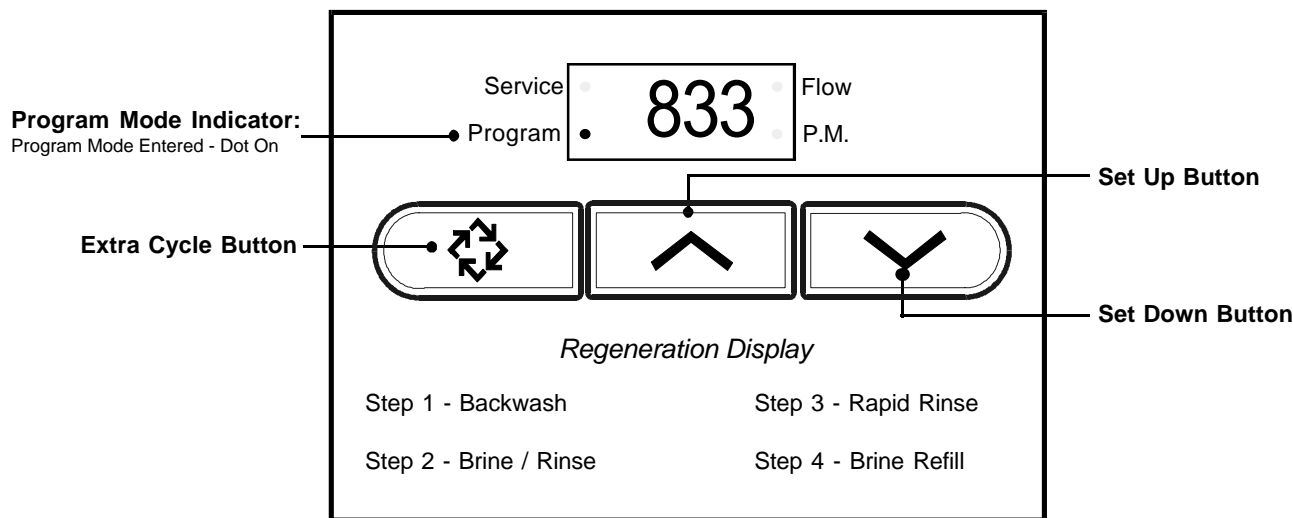

1. The first option setting display that appears in the Program Mode is Treated Water Capacity. Using the Set Up or Down Buttons, set the amount of treated water that can flow through the unit before a regeneration is required. For Example

650 Gallons Capacity Service Flow
Program **650** P.M.

2. Push the Extra Cycle Button. The second option setting display that appears is Regeneration Time. Using the Set Up or Down Buttons, set the desired time of day when a regeneration can occur, if required. For Example:

2:00 A.M. Regeneration Time Service Flow
Program **2:00** P.M.

3. Push the Extra Cycle Button. The third option setting display that appears is Regeneration Day Override. Using the Set Up or Down Buttons, set the maximum number of days before a regeneration cycle must occur. For Example:

Regenerate Every
7 Days Minimum Service Flow
Program **A - -7** P.M.

4. Control programming is now complete. Push the Extra Cycle Button. This will exit the control from the Programming Mode, and resume Normal Operation.

MODEL 5600SE Downflow

Control Start-Up Procedures, Continued

4

Set Control Programming

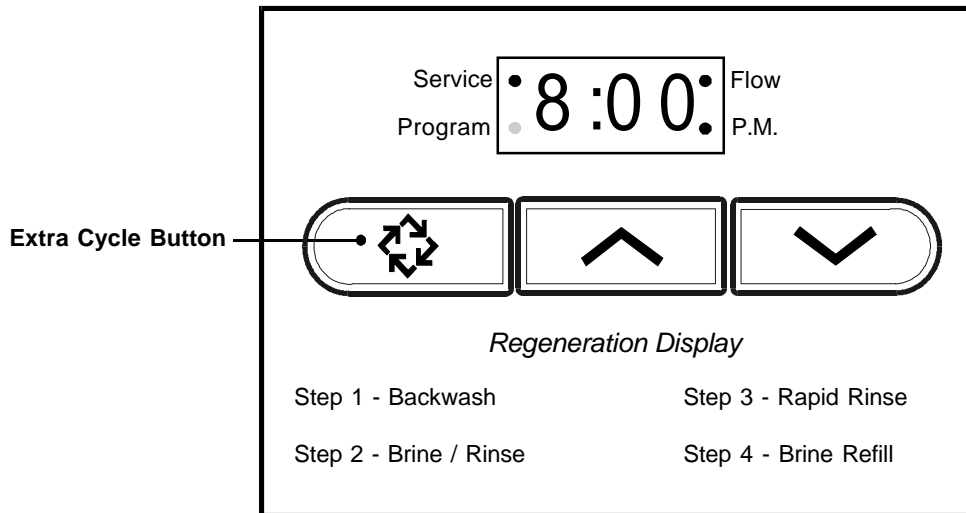

When starting an Extra Cycle, you will have one or two options:

1. Press and Release the Extra Cycle Button:

- With *Immediate Regeneration* controls the control will go into regeneration cycle immediately.
- With *Delayed Regeneration* controls the Service Arrow will begin to flash immediately and a regeneration will occur at the preset regeneration time (i.e. 2:00 a.m.)

2. Press and Hold for 5 seconds the Extra Cycle Button:

- With *Delayed Regeneration* controls this will force the control to go into regeneration cycle immediately.

5

Regeneration Cycle Displays

The following series of displays appear when the control enters a regeneration cycle:

Valve Driving To Regen. Step #1	Service Program	1 - - -	Flow P.M.	Then	Service Program	1 - - -	Flow P.M.	Less Than 9 Min. Remain In Regen. Step #1
Valve Driving To Regen. Step #2	Service Program	2 - - -	Flow P.M.	Then	Service Program	2-58	Flow P.M.	Less Than 59 Min. Remain In Regen. Step #2
Valve Driving To Regen. Step #3	Service Program	3 - - -	Flow P.M.	Then	Service Program	3 - - 8	Flow P.M.	Less Than 9 Min. Remain In Regen. Step #3
Valve Driving To Regen. Step #4	Service Program	4 - - -	Flow P.M.	Then	Service Program	2-11	Flow P.M.	Less Than 12 Min. Remain In Regen. Step #4
Regen Complete. Valve Driving To Service	Service Program	- - - -	Flow P.M.	Then	Service Program	8:00	Flow P.M.	Valve Has Returned To Service

MODEL 5600SE Downflow

Control Start-Up Procedures, Continued

6

Fast Cycle Valve Thru Regeneration

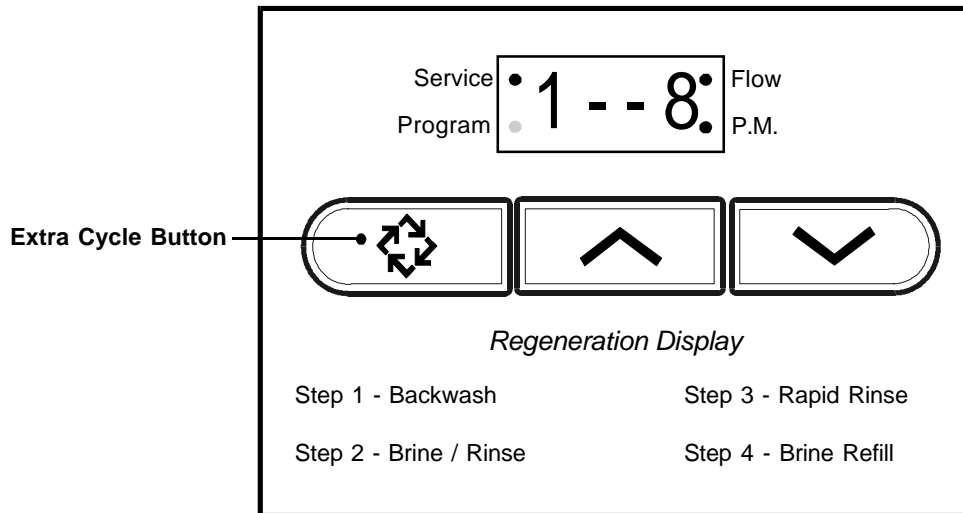

A. Once the valve reaches Regen Step #1 let water run to drain for about 5 minutes.

Next, manually step the valve through a regen cycle checking valve operation in each step:

- B. Push the Extra Cycle Button once to advance the valve to Regen Step #2.
- C. Push the Extra Cycle Button once to advance the valve to Regen Step #3. (Optional)
- D. Push the Extra Cycle Button once to advance the valve to Regen Step #4. (Optional)
- E. Push the Extra Cycle Button once more to advance the valve back to Service.

7

Final Set-Up

The following series of displays appear when the control enters a regeneration cycle:

With proper valve operation verified:

- A. Add water to the top of the air check. Manually step the valve to the Brine Draw Position and allow the valve to draw water from the brine tank until it stops. Note: The air check will check at approximately the midpoint of the screened intake area.
- B. Next, manually step the valve to the Brine Refill Position and allow the valve to return to Service automatically.
- C. With the valve in Service, check that there is about 1.0" of water above the grid in the brine tank, if used.
- D. Fill the brine tank with salt.
- E. Set-Up is now finished, the control can now be left to run automatically.

MODEL 5600SE Downflow

Control Operation

Timeclock Regeneration Valves

In normal operation the Time Of Day Display will be viewed at all times. The control will operate normally until the number of days since the last regeneration reaches the Regeneration Day Override setting. Once this occurs, a regeneration cycle will then be initiated at the preset Regeneration Time.

Flow Meter Equipped Valves

In normal operation the Time Of Day Display will alternate being viewed with a Volume Remaining Display. This display will be in gallons. As treated water is used, the Volume Remaining Display will count down from a maximum value to zero or (----). Once this occurs a regeneration cycle will then be initiated immediately or delayed to the set Regeneration Time. Water flow through the valve is indicated by the Flow Dot that will flash in a direct relationship to flow rate. For Example:

833 Gallons Of Treated Water Remaining	Service	• 8 3 3 •	Flow
	Program	• 8 3 3 •	P.M.

0 Gallons Of Treated Water Remaining	Service	• - - - •	Flow
	Program	• - - - •	P.M.

Immediate Regeneration Valves With Days Between Regeneration Override Set

When the valve reaches its set Days Since Regeneration Override value a regeneration cycle will be initiated immediately. This event occurs regardless of the Volume Remaining display having reached zero gallons.

Delayed Regeneration Valves With Days Between Regeneration Override Set

When the valve reaches its set Days Since Regeneration Override value a regeneration cycle will be initiated at the preset Regeneration Time. This event occurs regardless of the Volume Remaining display having reached zero gallons.

Control Operation During Regeneration

In Regeneration the control will display a special *Regeneration Display*. In this display the control will show the current regeneration step number the valve is advancing to, or has reached, and the time remaining in that step. The step number displayed will flash until the valve has completed driving to this regeneration step position. Once all regeneration steps have been completed the valve will return to Service and resume normal operation.

For Example:

Less Than 6 Minutes Remaining In Regen Step #1	Service	• 1 - - 5 •	Flow
	Program	• 1 - - 5 •	P.M.

Pushing the Extra Cycle Button during a regeneration cycle will immediately advance the valve to the next cycle step position and resume normal step timing.

Control Operation During Programming

The control will only enter the Program Mode with the valve in Service. While in the Program Mode the control will continue to operate normally monitoring water usage and keeping all displays up to date. Control programming is stored in memory permanently, without the need for battery backup power.

Control Operation During A Power Failure

During a power failure all control displays and programming will be stored for use upon power re-application. *The control will retain these values for years, if necessary, without loss.* The control will be fully inoperative and any calls for regeneration will be delayed. The control will upon power re-application resume normal operation from the point were it was interrupted. *An indication that a power outage has occurred will be an inaccurate time of day display.*

MODEL 5600SE Downflow

Water Conditioner Flow Diagrams (downflow brining)

Using Black Cycle Cam (P/N 17438)

Service Position

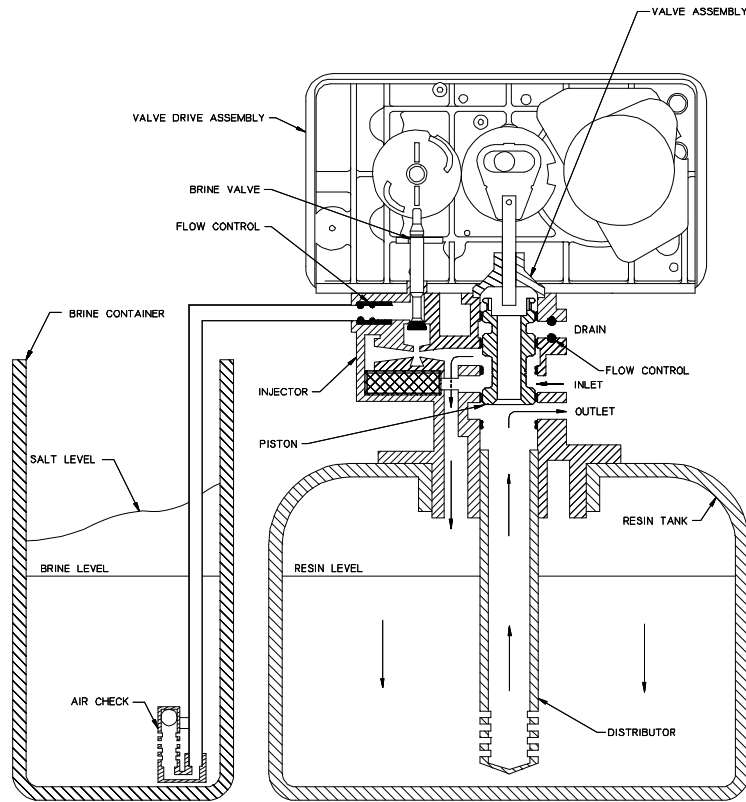

Backwash

Position

(Regeneration Cycle Step #1)

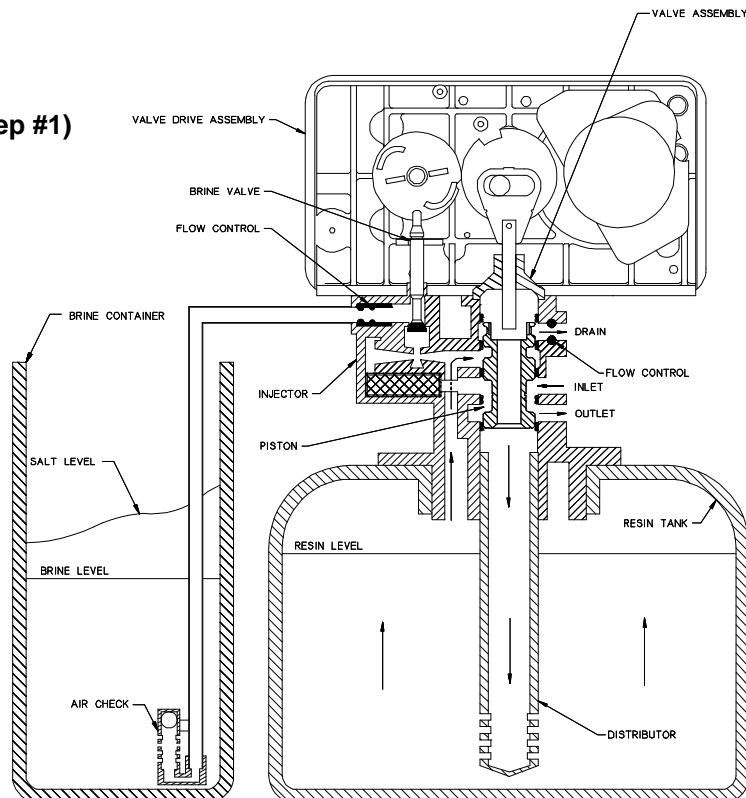

MODEL 5600SE Downflow

Water Conditioner Flow Diagrams (downflow brining)

Using Black Cycle Cam (P/N 17438), Continued

Brine/Slow Rinse Position

(Regeneration Cycle Step #2)

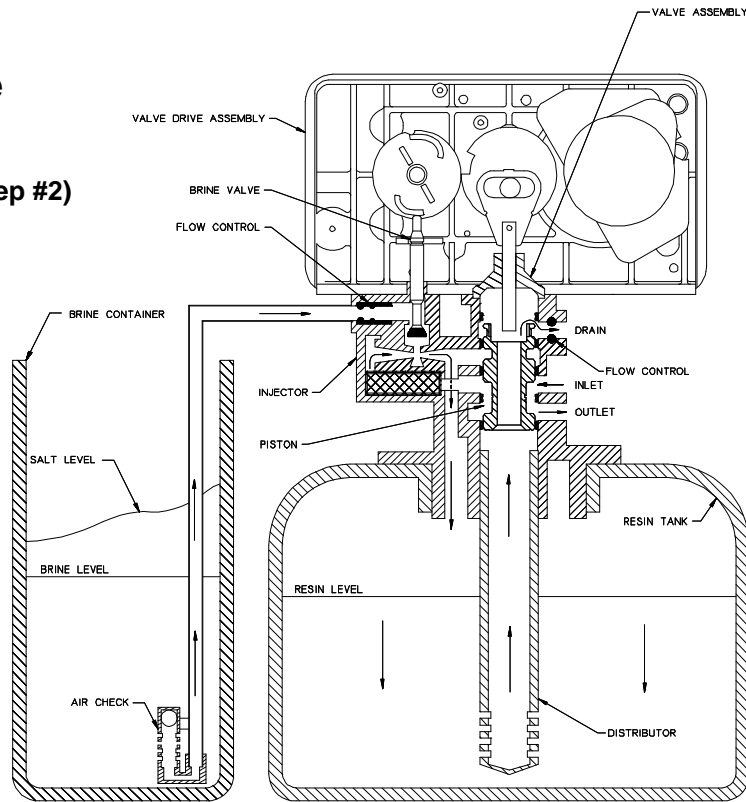

Rapid Rinse Position

(Regeneration Cycle Step #3)

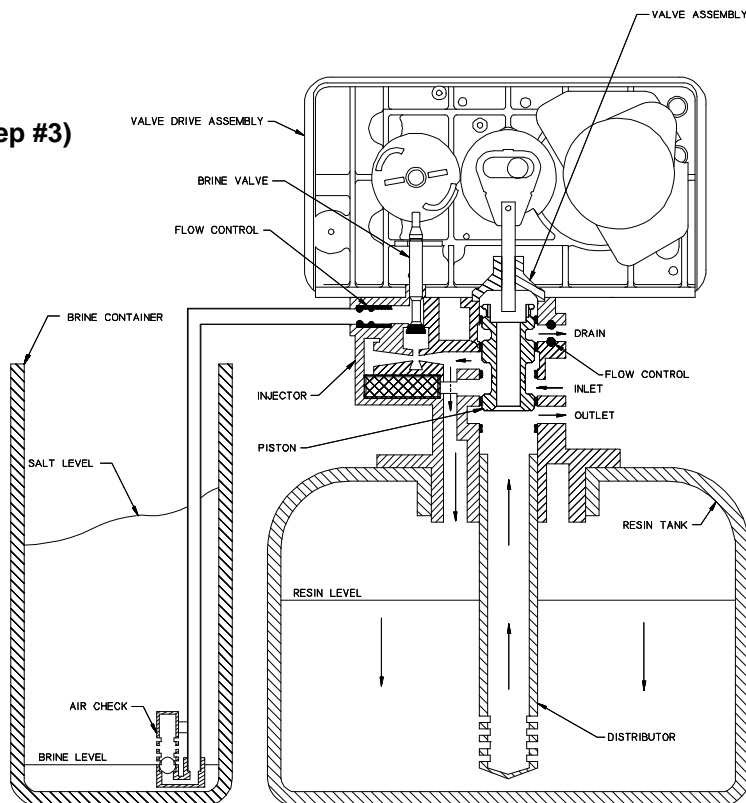

MODEL 5600SE Downflow

Water Conditioner Flow Diagrams (downflow brining)

Using Black Cycle Cam (P/N 17438), Continued

Brine Tank

Fill Position

(Regeneration Cycle Step #4)

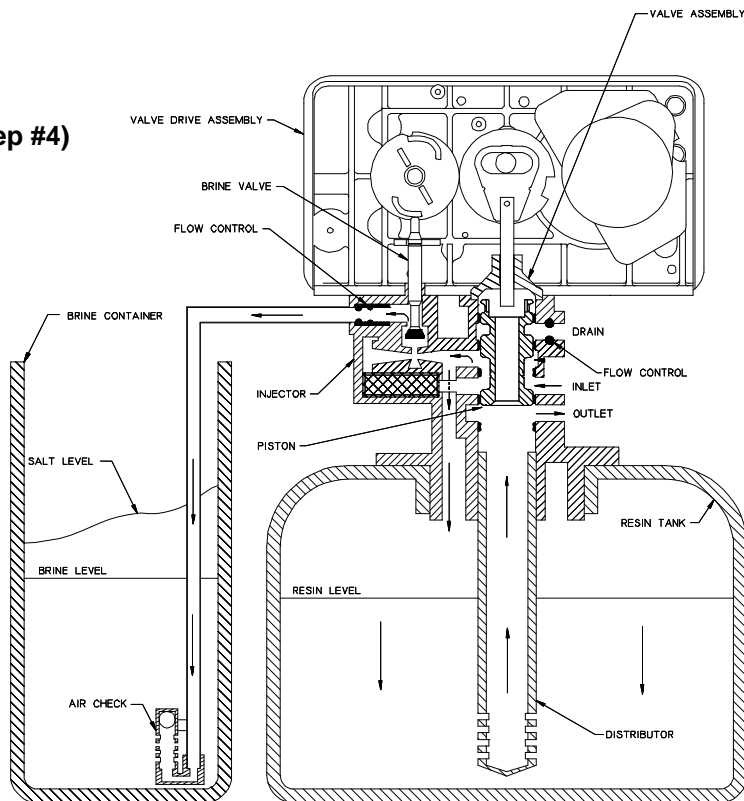

Service Position

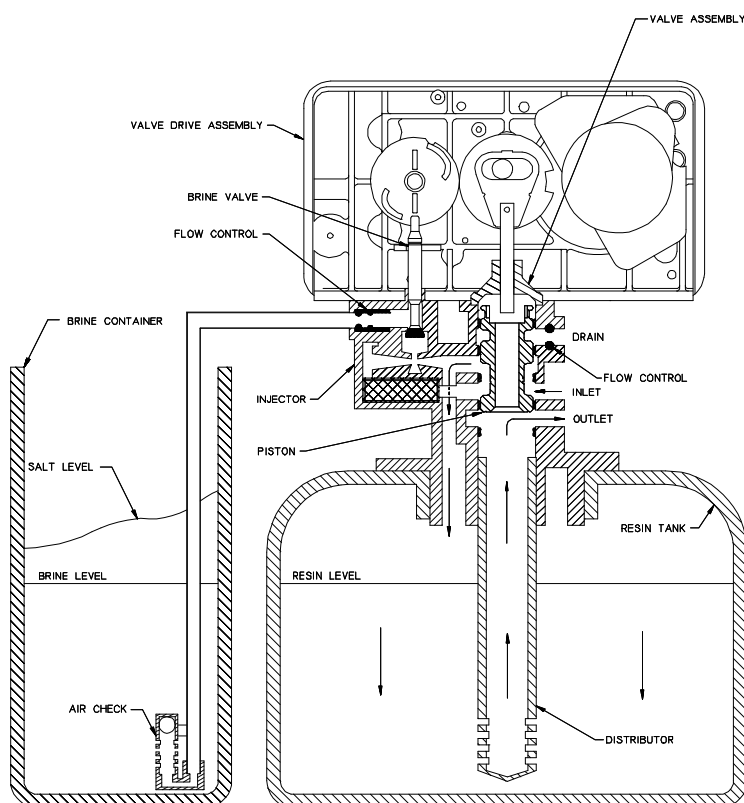

MODEL 5600SE Downflow

Control Valve Assembly

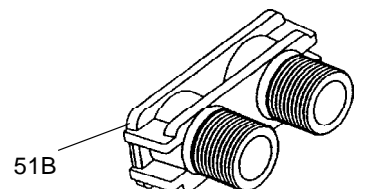

MODEL 5600SE Downflow

Control Valve Assembly Part List

Item No.	Quantity	Part No.	Description
* 1	2	13255	Adapter Clip
2	5	13242	Seal
3	161400-12	Valve Body Assembly - 1" dist.
	161400-11	Valve Body Assembly - 13/16" Dist.
4	1	13304	"O" Ring - Distributor Tube - 1"
	1	10244	"O" Ring - Distributor Tube - 13/16"
5	1	12281	"O" Ring - Top of Tank
6			Not Assigned
7	4	14241	Spacer
8	1	17218	Piston (Used with Black Cycle Cam)
9	1	13306	Piston Pin
10	1	13001-04	Piston Rod Assembly
11	1	14309	Piston Retainer
12	1	13446-40	End Plug Assembly - Green
14	2	13315	Screw - Injector Mounting
*15	2	19228	Adapter Coupling
*16	4	13305	"O" Ring - Adapter Coupling
*17	2	13314	Screw - Adapter Coupling
18	1	12638	"O" Ring - Drain
19	2	13301	"O" Ring - Injector
20	2	13302	"O" Ring - Brine Spacer
21	1	13303	"O" Ring - Injector Cover
22	1	13163	Injector Body
23	1	10913	Injector Nozzle - Specify Size
24	1	10914	Injector Throat - Specify Size
25	1	10227	Injector Screen
26	1	13166	Injector Cover
27	1	13172	Brine Valve Stem
28	1	12626	Brine Valve Seat
29	1	13165	Brine Valve Cap
30	1	13167	Brine Valve Spacer
31	1	12550	Quad Ring
32	1	11973	Spring - Brine Valve
33	1	16098	Washer - Brine Valve
34	1	11981-01	Retaining Ring
35	1	10329	B.L.F.C. Fitting Nut 3/8"
36	1	10330	B.L.F.C. Ferrule 3/8"
37	1	10332	B.L.F.C. Tube Insert 3/8"
38	1		B.L.F.C. Button - Specify Size
39	1	12977	"O" Ring - B.L.F.C.
40	1	13245	B.L.F.C. Button Retainer
41	1	13244	B.L.F.C. Fitting
42	1		D.L.F.C. Button - Specify Size
43	1	13173	D.L.F.C. Button Retainer
44	1	12767	Screen - Brine Line
45	1	15348	"O" Ring - D.L.F.C.
46	1	13497	Air Disperser
47	1	13546	End Plug Retainer
48	3	12112	Screw
49	1	13363	Washer
50	1	13296	Screw
51A	1	13398	Yoke, Brass, 1" NPT
	1	13708	Yoke, Brass, 3/4" NPT
51B	1	18706	Yoke, Plastic, 1" NPT
	1	18706-02	Yoke, Plastic, 3/4" NPT
52	1	13308	Drain Hose Barb

* Not used with meter controls.

MODEL 5600SE Downflow

Valve Powerhead Assembly

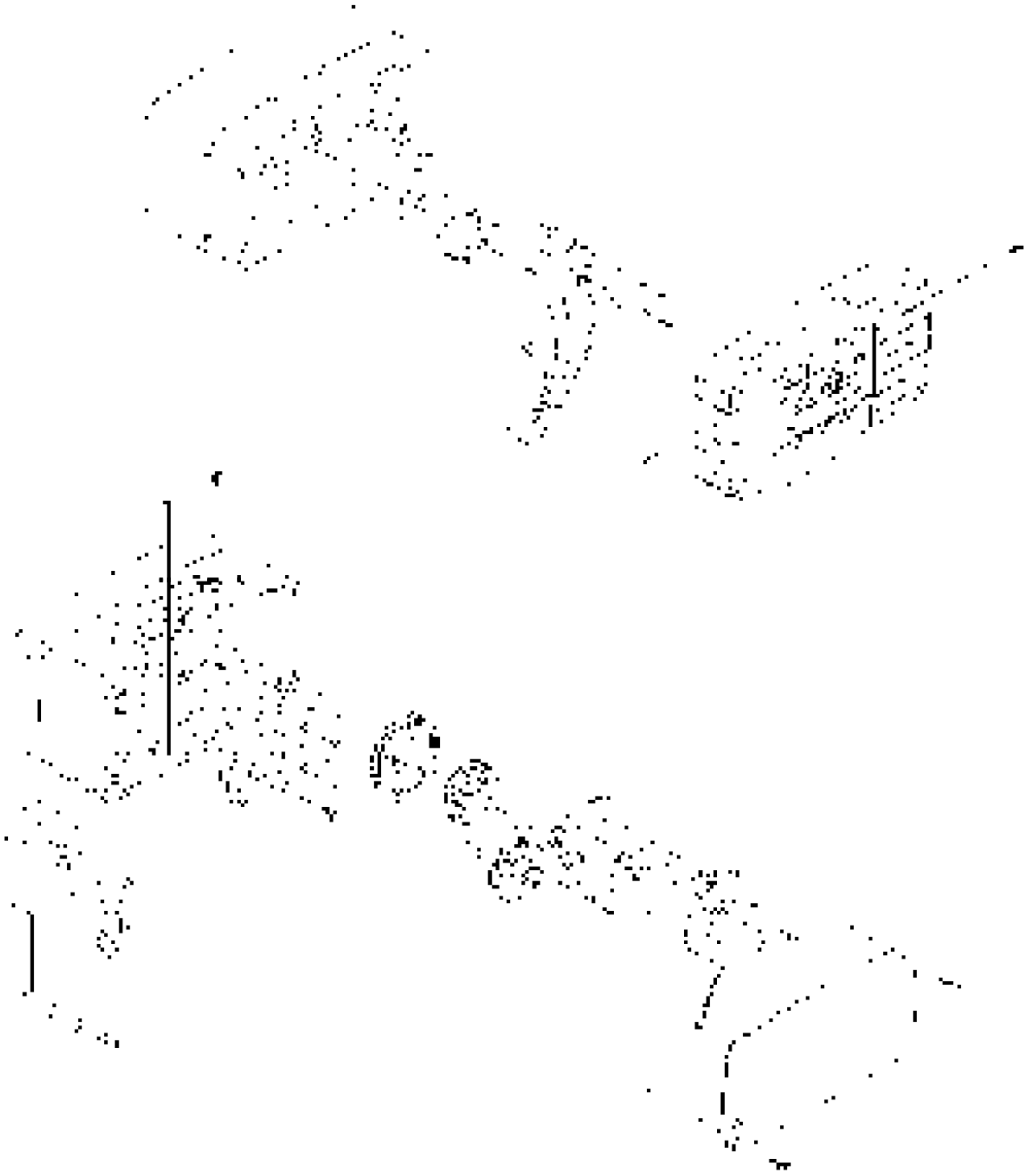

MODEL 5600SE Downflow

Valve Powerhead Assembly, Continued

Item No.	Quantity	Part No.	Description
1	1	26001-02	Drive Housing, Black
2	2	12473	Screw, Drive Mount
3	1	19474	Wire Harness, Power
4	1	13299	Spring Washer
5	1	13017	Idler Gear
6	2	19080	Spring, Detent
7	2	13300	Ball, Detent
8	1	25005	Main Drive Gear & Shaft (Downflow Brining - Black)
9	1	23045	Drive Gear
10	1	13175	Motor Mounting Plate
11	1	16944	Drive Motor 2RPM 24V 50/60Hz
12	3	11384	Screw, Motor
13	1	13229	Back Plate
14	5	13296	Screw, Component
15	1	12037	Washer
16	1	18722	Cam, Brine Valve
17	1	19674	Transformer, 24V 9.6VA (Optional)
18	1	13547	Strain Relief
19	1	19079	Washer, Friction
20	1	17438	Cycle Cam (Downflow Brining - Black)
21	1	10302	Insulator
22	2	17876	Screw, Microswitch
23	1	60755-021	Front Panel Assembly (Backwash First Label, Black)
24	2	13898	Screw, Front Panel
25	2	10218	Microswitch
26	1	15151	Screw, Cycle Cam
27	4	12681	Wire Nut, Grey (Not Shown)

MODEL 5600SE Downflow

3/4" Turbine Meter Assembly

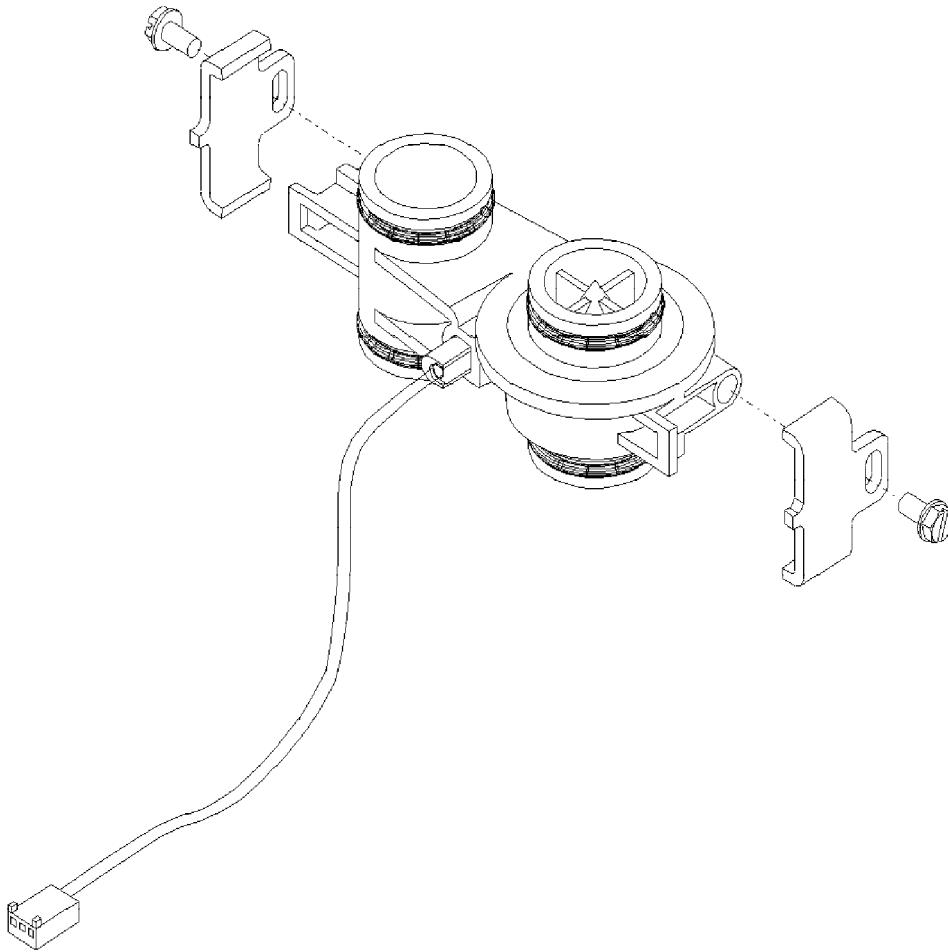

Parts List

Item No.	Quantity	Part No.	Description
1	2	13314	Screw, Hex Washer, 8-18 x 5/8
2	2	19569	Clip, Flow Meter
3	1	19797	Meter Body Assembly, 3/4" Turbine
4	4	13305	O Ring, -119
5	1	19791-01	Harness Assembly, Flow Meter
6	1	14613	Flow Straightener (Not Shown)

MODEL 5600SE Downflow

By-Pass Valve Assembly, Plastic

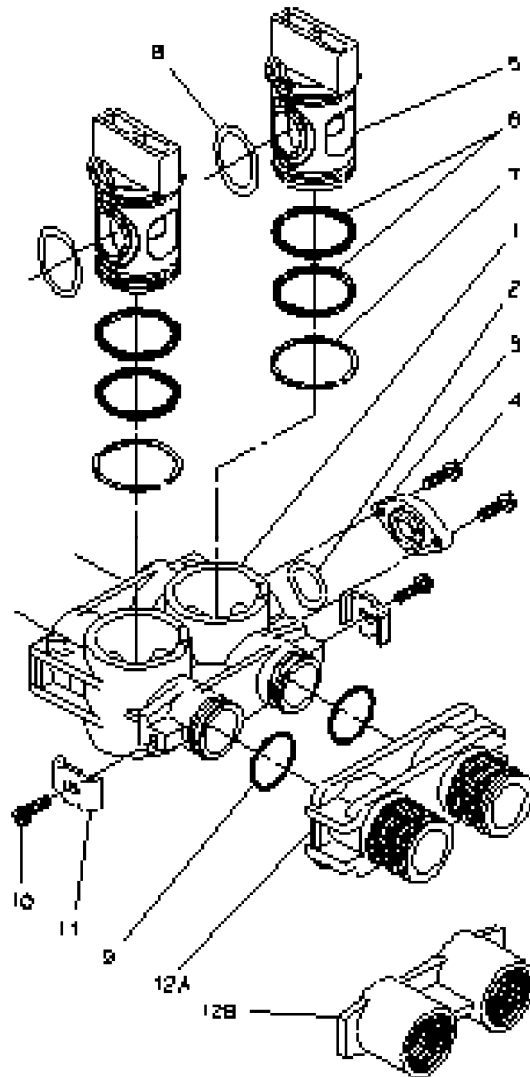

Parts List

Item No.	Quantity	Part No.	Description
1	1	19723	By-Pass Valve Body, Plastic
2	1	11183	O Ring, -015
3	1	19724	Cap, By-Pass
4	2	17512	Screw, Hex Washer Head, #6-24 x 3
5	2	17820	Plug, By-Pass
6	4	18661	O Ring, -218
7	2	18662	Retaining Ring
8	2	18660	O Ring
9	2	13305	O Ring, -119
10	2	13255	Clip, Mounting
11	2	13314	Screw, Hex Washer Head, 8-18 x 5/8
12A	1	18706	Yoke, Plastic, 1" NPT
		18706-02	Yoke, Plastic, 3/4" NPT
12B	1	13708	Yoke, Brass, 3/4" NPT
		13708NP	Yoke, 3/4" NPT Nickel Plated
		13398	Yoke, Brass, 1" NPT
		13398NP	Yoke, 1" NPT Nickel Plated

MODEL 5600SE Downflow

By-Pass Valve Assembly, Brass

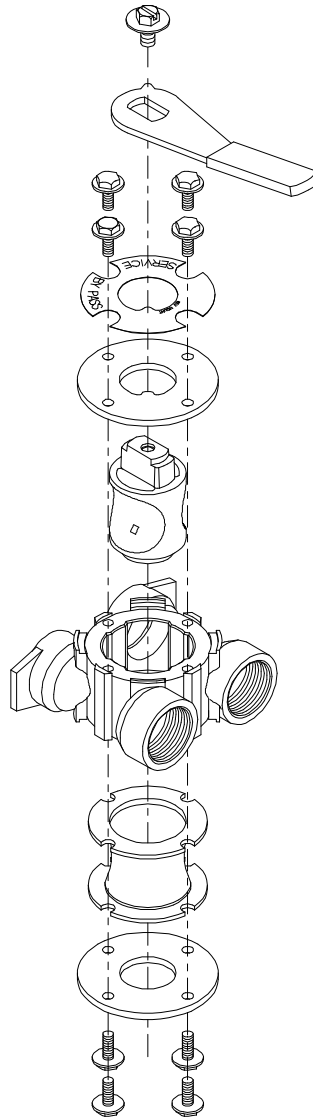

Parts List

Item No.	Quantity	Part No.	Description
1	1	17290	By-Pass Valve Body, 3/4"
	1	17290NP	By-Pass Valve Body, 3/4" Nickel Plate
	1	13399	By-Pass Valve Body, 1"
	1	13399NP	By-Pass Valve Body, 1", Nickel Plate
2	1	11726	Seal, By-Pass
3	1	11972	Plug, By-Pass
4	1	11978	Side Cover
5	1	13604-01	Label
6	8	15727	Screw
7	1	11986	Side Cover
8	1	11979	Lever, By-Pass
9	1	11989	Screw, Hex Head, 1/4-14

MODEL 5600SE Downflow

2300 Safety Brine Valve

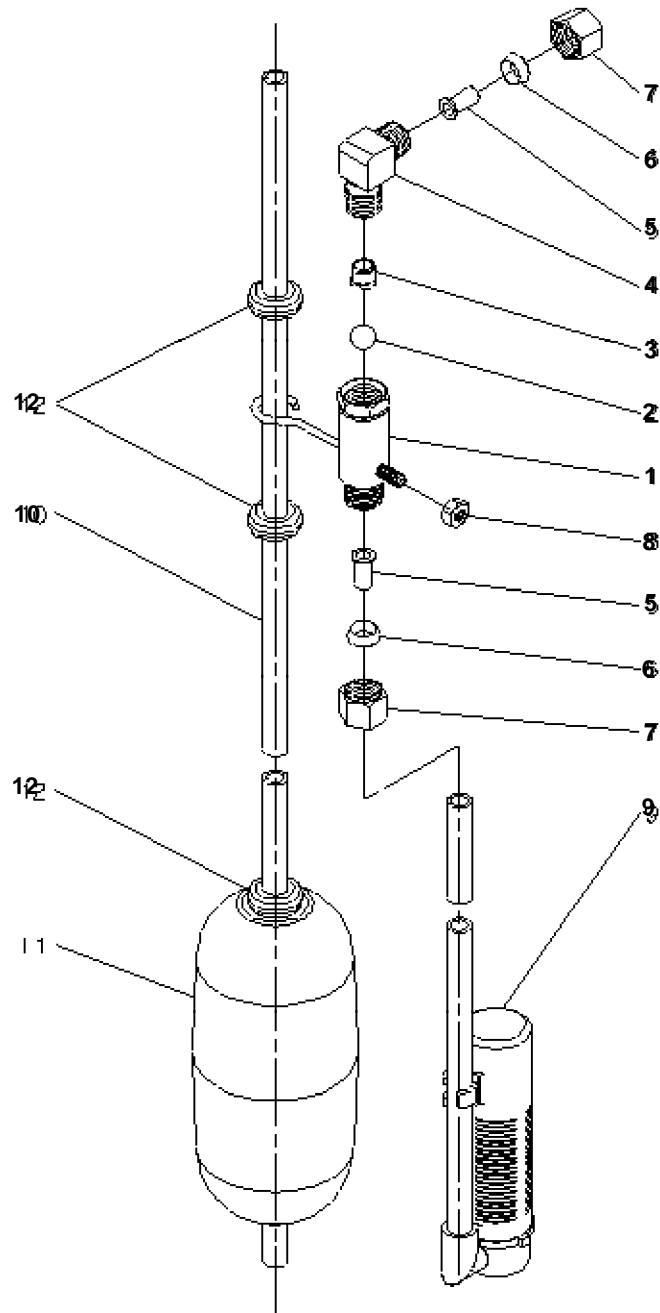

Parts List

Item No.	Quantity	Part No.	Description
1	1	60027-00	2300 Safety Brine Valve Body
2	1	10138	Ball, 3/8"
3	1	11566	Bull Stop
4	1	10328	Elbow, 1/4 x 1/4 T
5	2	10332	Insert, 3/8
6	2	10330	Sleeve, 3/8
7	2	10329	Tube Nut, 3/8
8	1	10186	Nut, Hex, 10-32, Nylon
9	1	60002	#500 Air Check
10	1	10149	Float Rod, 30"
11	1	10700	Float Assembly, Blue/White
12	4	10150	Grommet

MODEL 5600SE Downflow

Valve Wiring Diagram

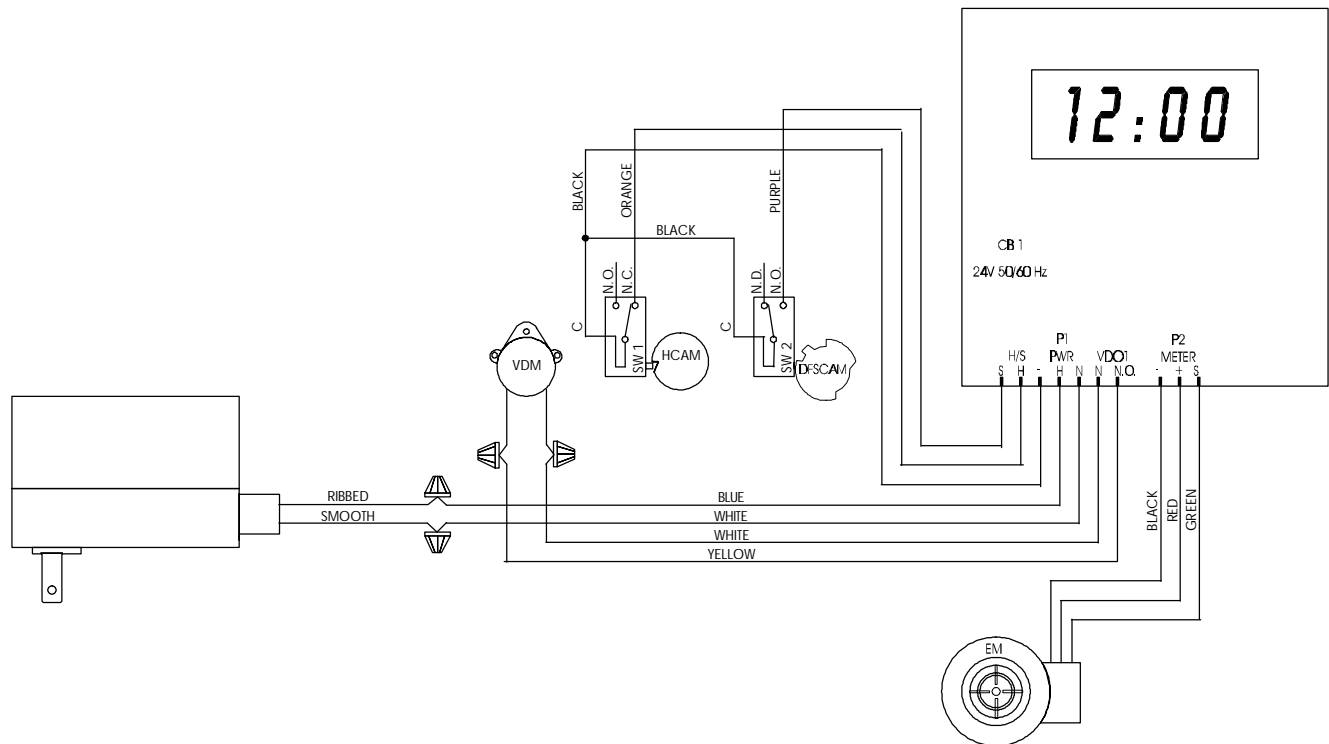

- CB1 - 5600SE Circuit Board
- VDM - Valve Drive Motor
- EM - Electronic Flow Meter (Optional)
- SW1 - Homing Switch
- SW2 - Step Switch
- HCAM - Homing Cam
- DFSCAM - Downflow Step Cam

Model 5600SE Downflow

Service Instructions

A. TO REPLACE BRINE VALVE, INJECTORS, AND SCREEN

1. Turn off water supply to conditioner:
 - a. If the conditioner installation has a "three valve" by-pass system, first open the valve in the by-pass line, then close the valves at the conditioner inlet and outlet.
 - b. If the conditioner has an integral by-pass valve, put it in the by-pass position.
 - c. If there is only a shut-off valve near the conditioner inlet, close it.
2. Relieve water pressure in the conditioner by stepping the control into the backwash position momentarily. Return the control to the service position.
3. Unplug electrical cord from outlet.
4. Disconnect brine tube and drain line connections at the injector body.
5. Remove the two injector body mounting screws. The injector and brine module can now be removed from the control valve. Remove and discard brine body "O" rings.
- 6A. To replace brine valve.
 1. Pull brine valve from injector body, also remove and discard "O" ring at bottom of brine valve hole.
 2. Apply silicone lubricant to new "O" ring and reinstall at bottom of brine valve hole.
 3. Apply silicone lubricant to "O" ring on new valve assembly and press into brine valve hole, shoulder on bushing should be flush with injector body.
- 6B. To replace injectors and screen.
 1. Remove injector cap and screen, discard "O" ring. Unscrew injector nozzle and throat from injector body.
 2. Screw in new injector throat and nozzle, be sure they are sealed tightly. Install a new screen.
 3. Apply silicone lubricant to new "O" ring and install around oval extension on injector cap.
7. Apply silicone lubricant to three new "O" rings and install over three bosses on injector body.
8. Insert screws thru injector cap and injector. Place this assembly thru hole in timer housing and into mating holes in the valve body. Tighten screws.
9. Reconnect brine tube and drain line.
10. Return by-pass or inlet valving to normal service position. Water pressure should now be applied to the conditioner, and any by-pass line shut off.
11. Check for leaks at all seal areas. Check drain seal with the control in the backwash position.
12. Plug electrical cord into outlet.
13. Set time of day and cycle the control valve manually to assure proper function. Make sure control valve is returned to the service position.
14. Make sure there is enough salt in the brine tank.
15. Start regeneration cycle manually if water is hard.

B. TO REPLACE TIMER

1. Follow Steps A.1 through A.3 .
2. Remove the control valve back cover. Remove the control valve front cover. Disconnect the meter dome signal wire from the front cover and feed it back through the control.
3. Remove screw and washer at drive yoke. Remove timer mounting screws. The entire timer assembly will now lift off easily.

4. Put new timer on top of valve. Be sure drive pin on main gear engages slot in drive yoke.
5. Replace timer mounting screws. Replace screw and washer at drive yoke. Replace meter signal wire.
6. Return by-pass or inlet valving to normal service position. Water pressure should now be applied to the conditioner, and any by-pass line shut off.
7. Replace the control valve back cover.
8. Follow Steps A.12 through A.15 .

C. TO REPLACE PISTON ASSEMBLY

1. Follow Steps A.1 through A.3 .
2. Remove the control valve back cover. Remove the control valve front cover. Disconnect the meter dome signal wire from the front cover and feed it back through the control.
3. Remove screw and washer at drive yoke. Remove timer mounting screws. The entire timer assembly will now lift off easily. Remove end plug retainer plate.
4. Pull upward on end of piston yoke until assembly is out of valve.
5. Inspect the inside of the valve to make sure that all spacers and seals are in place, and that there is no foreign matter that would interfere with the valve operation.
6. Take new piston assembly as furnished and push piston into valve by means of the end plug. Twist yoke carefully in a clockwise direction to properly align it with drive gear. Replace end plug retainer plate.
7. Place timer on top of valve. Be sure drive pin on main gear engages slot in drive yoke.
8. Replace timer mounting screws. Replace screw and washer at drive yoke.
9. Return by-pass or inlet valving to normal service position. Water pressure should now be applied to the conditioner, and any by-pass line shut off.
10. Replace the control valve back cover.
11. Follow Steps A.12 through A.15 .

D. TO REPLACE SEALS AND SPACERS

1. Follow Steps A.1 through A.3 .
2. Remove the control valve back cover. Remove the control valve front cover. Disconnect the meter dome signal wire from the front cover and feed it back through the control.
3. Remove screw and washer at drive yoke. Remove timer mounting screws. The entire timer assembly will now lift off easily. Remove end plug retainer plate.

MODEL 5600SE Downflow

Service Instructions, Continued

4. Pull upward on end of piston rod yoke until assembly is out of valve. Remove and replace seals and spacers.
5. Take piston assembly and push piston into valve by means of the end plug. Twist yoke carefully in a clockwise direction to properly align it with drive gear. Replace end plug retainer plate.
6. Place timer on top of valve. Be sure drive pin on main gear engages slot in drive yoke.
7. Replace timer mounting screws. Replace screw and washer at drive yoke.
8. Return by-pass or inlet valving to normal service position. Water pressure should now be applied to the conditioner, and any by-pass line shut off.
9. Replace the control valve back cover.
10. Follow Steps A.12 through A.15 .

E. TO REPLACE METER

1. Follow Steps A.1 through A.3 .
2. Remove two screws and clips at by-pass valve or yoke. Pull resin tank away from plumbing connections.
3. Pull meter module out of control valve.
4. Remove signal wire from meter module, (snap tab on end opposite wire cable).
5. Apply silicone lubricant to four new "O" rings and assemble to four ports on new meter module.
6. Install signal wire into new meter module.
7. Assemble meter to control valve. Note, meter portion of module must be assembled at valve outlet.
8. Push resin tank back to the plumbing connections and engage meter ports with by-pass valve or yoke.
9. Attach two clips and screws at by-pass valve or yoke. Be sure clip legs are firmly engaged with lugs.
10. Return by-pass or inlet valving to normal service position. Water pressure should now be applied to the conditioner, and any by-pass line shut off.
11. Check for leaks at all seal areas.
12. Follow Steps A.12 through A.15 .

MODEL 5600SE Downflow

Service Instructions, Continued

PROBLEM	CAUSE	CORRECTION
1. Softener Fails To Regenerate.	A. Electrical Service To Unit Has Been Interrupted.	A. Assure Permanent Electrical Service (Check Fuse, Plug, Pull Chain or Switch).
	B. Timer Is Not Operating Properly.	B. Replace Timer.
	C. Defective Valve Drive Motor.	C. Replace Drive Motor.
	D. Timer Programming Bad (Improper Programming)	D. Check Programming and Reset As Needed.
2. Softener Delivers Hard Water.	A. By-Pass Valve Is Open.	A. Close By-Pass Valve.
	B. No Salt In Brine Tank.	B. Add Salt To Brine Tank And Maintain Salt Level Above Water Level.
	C. Injectors Or Screen Plugged.	C. Replace Injectors And Screen.
	D. Insufficient Water Flowing Into Brine Tank.	D. Check Brine Tank Fill Time And Clean Brine Line Flow Control If Plugged.
	E. Hot Water Tank Hardness.	E. Repeated Flushings Of The Hot Water Tank Is Required.
	F. Leak At Distributor Tube.	F. Make Sure Distributor Tube Is Not Cracked. Check "O" Ring And Tube Pilot.
	G. Internal Valve Leak.	G. Replace Seals And Spacers And/Or Piston.
	H. Flow Meter Jammed.	H. Remove obstruction from flow meter.
	I. Flow Meter Cable Disconnected or Not Plugged Into Meter.	I. Check Meter Cable Connection to Timer and Meter.
	J. Improper Programming.	J. Reprogram the control to the proper Regeneration Type, Inlet Water Hardness, Capacity or Flow Meter Size.
3. Unit Uses Too Much Salt.	A. Improper Salt Setting.	A. Check Salt Usage And Salt Setting.
	B. Excessive Water In Brine Tank.	B. See Problem No. 7.
	C. Improper Programming.	C. Check Programming and Reset As Needed.
4. Loss Of Water Pressure.	A. Iron Buildup In Line To Water Conditioner.	A. Clean Line To Water Conditioner.
	B. Iron Buildup In Water Conditioner.	B. Clean Control And Add Resin Cleaner To Resin Bed. Increase Frequency Of Regeneration.
	C. Inlet Of Control Plugged Due To Foreign Material Broken Loose From Pipes By Recent Work Done On Plumbing System.	C. Remove Piston And Clean Control.
5. Loss Of Resin Through Drain Line.	A. Air In Water System.	A. Assure That Well System Has Proper Air Eliminator Control. Check For Dry Well Condition.
	B. Drain Line Flow Control Is Too Large.	B. Ensure Drain Line Flow Control Is Sized Correctly.

MODEL 5600SE Downflow

Service Instructions, Continued

PROBLEM	CAUSE	CORRECTION
6. Iron In Conditioned Water.	A. Fouled Resin Bed.	A. Check Backwash, Brine Draw And Brine Tank Fill, Increase Frequency Of Regeneration. Increase Backwash Time.
	B. Iron Content Exceeds Recommended Parameters	B. Add Iron Removal from Filter or System
7. Excessive Water In Brine Tank.	A. Plugged Drain Line Flow Control.	A. Clean Flow Control.
	B. Brine Valve Failure	B. Replace Brine Valve.
	C. Improper Programming.	C. Check Programming and Reset as Needed.
8. Salt Water In Service line.	A. Plugged Injector System.	A. Clean Injector And Replace Screen.
	B. Timer Not Operating Properly.	B. Replace Timer.
	C. Foreign Material In Brine Valve.	C. Clean Or Replace Brine Valve.
	D. Foreign Material In Brine Line Flow Control.	D. Clean Brine Line Flow Control.
	E. Low Water Pressure.	E. Raise Water Pressure.
	F. Improper Programming.	F. Check Programming and Reset as Needed.
9. Softener Fails To Draw Brine.	A. Drain Line Flow Control Is Plugged.	A. Clean Drain Line Flow Control.
	B. Injector Is Plugged.	B. Clean Or Replace Injectors.
	C. Injector Screen Plugged.	C. Replace Screen.
	D. Line Pressure Is Too Low.	D. Increase Line Pressure. (Line Pressure Must Be At Least 25 PSI At All Times.)
Or	E. Internal Control Leak.	E. Change Seals And Spacers And/ Piston Assembly.
	F. Improper Programming.	F. Check Programming and Reset as Needed.
	G. Timer Not Operating Properly.	G. Replace Timer.
10. Control Cycles Continuously.	A. Timer Not Operating Properly.	A. Replace Timer.
	B. Faulty Microswitches and or Harness.	B. Replace Faulty Microswitch or Harness.
	C. Faulty Cycle Cam Operation.	C. Replace Cycle Cam or Reinstall.
11. Drain Flows Continuously.	A. Foreign Material In Control.	A. Remove Piston Assembly And Inspect Bore, Remove Foreign Material & Check Control In Various Regeneration Positions.
	B. Internal Control Leak.	B. Replace Seals And/Or Piston Assembly.
	C. Control Valve Jammed In Brine Or Backwash Position.	C. Replace Piston And Seals And Spacers.
	D. Timer Motor Stopped Or Jammed.	D. Replace Timer Motor and Check All Gears for Missing Teeth.
	E. Timer Not Operating Properly.	E. Replace Timer.

MODEL 5600SE Downflow

Service Assemblies

60022-12 BLFC .125 GPM

	60022-25	BLFC .25 GPM
	60022-50	BLFC .50 GPM
	60022-100	BLFC 1.0 GPM

For Illustration, See Page 12

1	17307	Flow Washer .125 GPM
	12094	Flow Washer .25 GPM
	12095	Flow Washer .50 GPM
	12097	Flow Washer 1.0 GPM
1	12977	O-Ring, - 015
1	13244	Adapter, BLFC
1	13245	Retainer, BLFC

60032

Brine Valve

For Illustration, See Page 12

1	11973	Spring, Brine Valve
1	11981-01	Retaining Ring
1	12550	Quad Ring, -009
1	13165	Cap, Brine Valve
1	13167	Spacer, Brine Valve
2	13302	O-Ring, -014
1	16098	Washer, Plain, Nylon
1	13172	Brine Valve Stem
1	12626	Seat, Brine Valve

60040

By Pass, 3/4", Brass

60040NP

By Pass, 3/4", Nickel

60041

By Pass, 1", Brass

60041NP

By Pass, 1", Nickel

For Illustration and Parts List,
See Page 18

60049

Bypass, Plastic, 3/4"

For Illustration and Parts List,
See Page 17

60102-71

5600SE Piston Assembly – Downflow

For Illustration, See Page 12

1	14309	Piston Rod Retainer
1	13001-04	Piston Rod Assembly
1	13446-40	End Plug Assy. - Green
1	17218	Piston, Downflow Rapid Rinse

60125

5600SE Seal and Spacer Kit

For Illustration and Parts List,
See Pages 12 and 13

5	13242	Seal
4	14241	Spacer

60084 - Injector - Module Assembly

(Specify Inj. Number,
D.L.F.C. Size, B.L.F.C. Size)
For Illustration and Parts List,
See Pages 12 and 13

60626

5600SE Meter Assembly

For Illustration and Parts List,
See Page 16 **60755-021**

.....5600SE Front Panel Assembly

Black, Backwash First Label, DF/UF
For Illustration, See Page 14

60756-0211 5600SE Metered Powerhead Assembly

Black, Backwash First Label, DF
For Illustration, See Page 14

60757-02115600SE Timeclock Powerhead Assembly

Black, Backwash First Label, DF
For Illustration, See Page 14

